

## HTD63L TYPE

### TYPE

#### HTD 63L

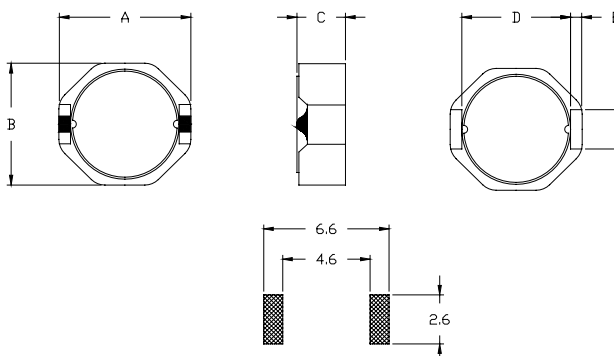

A: 6.8 MAX  
 B: 6.2 MAX  
 C: 3.0 MAX  
 D: 4.8 REF  
 E: 0.6 REF  
 F: 2.0 REF

### SPECIFICATION

ITEM	L ( $\mu$ H)	DCR (m $\Omega$ )	IDC MAX.(A)
1R0M	1.0 $\pm$ 20%	11	3.59
1R5M	1.5 $\pm$ 20%	13	2.93
2R2M	2.2 $\pm$ 20%	16	2.42
3R6M	3.6 $\pm$ 20%	21	1.89
4R7M	4.7 $\pm$ 20%	27	1.66
6R2M	6.8 $\pm$ 20%	32	1.45
100M	10 $\pm$ 20%	49	1.14
120M	12 $\pm$ 20%	52	1.04
150M	15 $\pm$ 20%	62	0.93
180M	18 $\pm$ 20%	74	0.85
220M	22 $\pm$ 20%	95	0.77
270M	27 $\pm$ 20%	120	0.70
330M	33 $\pm$ 20%	140	0.63
390M	39 $\pm$ 20%	150	0.58
470M	47 $\pm$ 20%	185	0.53
560M	56 $\pm$ 20%	220	0.48
680M	68 $\pm$ 20%	270	0.44
820M	82 $\pm$ 20%	330	0.40
101M	10 $\pm$ 20%	415	0.36
151M	150 $\pm$ 20%	616	0.31

M:  $\pm$ 20%

can design any part to your requirements with different inductance.

\* All parameters as this content presented are subject to final specifications both sides confirmed.