

## HCP139405 TYPE

### TYPE

#### HCP 139405

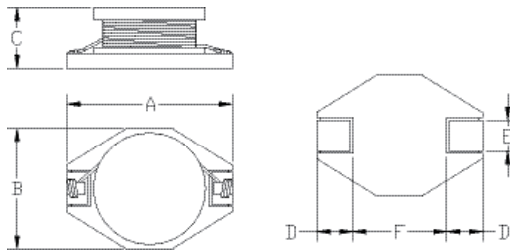

A: 12.95 MAX  
 B: 9.4 MAX  
 C: 5.21 MAX  
 D: 2.54  
 E: 2.54  
 F: 7.62

### SPECIFICATION

ITEM	L	SRF	DCR	IDC1	IDC2
HCP139405 (μH)	(MHz)	MAX.(Ω)	MAX.(A)	MAX.(A)	
1R0M	1.0	100	0.009	9.0	6.8
1R5M	1.5	90	0.010	8.0	6.4
2R2M	2.2	80	0.012	7.0	6.1
3R3M	3.3	65	0.015	6.4	5.4
4R7M	4.7	45	0.018	5.4	4.8
6R8M	6.8	38	0.027	4.6	4.4
100M	10	30	0.038	3.8	3.9
150M	15	27	0.046	3.0	3.1
220M	22	19	0.085	2.6	2.7
330M	33	15	0.10	2.0	2.1
470M	47	12	0.14	1.6	1.8
680M	68	10	0.20	1.4	1.5
101M	100	9	0.28	1.2	1.3
150M	15	6	0.40	1.0	1.0
221M	22	5	0.61	0.8	0.8
331M	33	4.5	1.02	0.6	0.6
471M	47	3.5	1.27	0.5	0.5
681M	68	2.5	2.02	0.4	0.4
102M	1000	2.0	3.00	0.3	0.3

M: ±20%

can design any part to your requirements with different inductance.

\* All parameters as this content presented are subject to final specifications both sides confirmed.